

LINEAR MOTORIZED VALVES

# CONTROL VALVE PN16 SERIES VLA121/VLA221 AND VLA131

ESBE control valves series VLA121/VLA221 and VLA131 are 2-way and 3-way internal threaded valves for PN16, DN 15-50.



Internal thread PN16      Internal thread PN16, pressure-balanced plug      Internal thread PN16

**MEDIA**

These valves can handle the following types of media:

- Hot and cold water.
  - Water with antifreeze additives such as glycol.
- If the valve is used for media at temperatures below 0°C (32°F), it should be equipped with a stem heater in order to prevent ice formation on the valve stem.

**OPTION**

Adaptor kit \_\_\_\_\_ Siemens SQX, Art. No. 2600 07 00

**CONTROL VALVE DESIGNED FOR**

- Heating
- Comfort Cooling
- Potable water
- Floor heating
- Solar heating
- Ventilation
- Zone
- District Hot Water
- District Heating
- District Cooling

**SUITABLE ACTUATORS**

The control valve series VLA121/VLA221 and VLA131 may most easily be fitted with ESBE actuators:

- Series ALA200
- Series ALB140
- Series ALD100
- Series ALD200

**TECHNICAL DATA**

Type: \_\_\_\_\_ 2- and 3-way plug valve  
 Pressure class: \_\_\_\_\_ PN 16  
 Flow characteristic A-AB: \_\_\_\_\_ EGM  
 Flow characteristic B-AB: \_\_\_\_\_ Complementary  
 Stroke: \_\_\_\_\_ 20 mm  
 Rangeability Kv/Kv<sup>min</sup>: \_\_\_\_\_ see table  
 Leakrate A-AB: \_\_\_\_\_ Tight sealing  
 Leakrate B-AB: \_\_\_\_\_ Tight sealing  
 ΔP<sub>max</sub>: \_\_\_\_\_ see tables pages 170-176  
 Media temperature: \_\_\_\_\_ max. +130°C  
 \_\_\_\_\_ min. -20°C  
 Connection: \_\_\_\_\_ Internal thread, EN 10226-1

**Material**

Body: \_\_\_\_\_ Nodular iron EN-JS 1030  
 Stem: \_\_\_\_\_ Stainless steel SS 2346  
 Plug: \_\_\_\_\_ Brass CW602N  
 Seat: \_\_\_\_\_ Nodular iron EN-JS 1030  
 Blind plug: \_\_\_\_\_ Brass CW602N  
 Seat seal: \_\_\_\_\_ EPDM  
 Packing box seal: \_\_\_\_\_ PTFE/EPDM

PED 97/23/EC, article 3.3

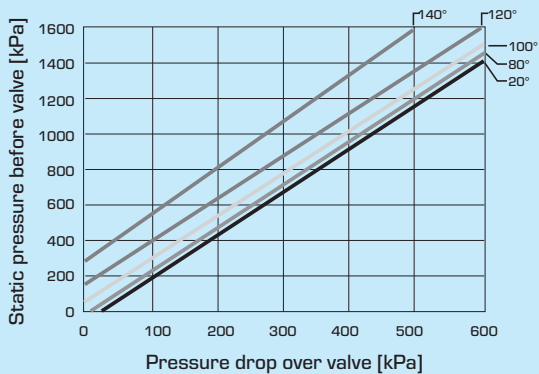

Pressure drop limit where cavitation might occur. Is dependent of valve inlet pressure and temperature of water.

**VALVE CHARACTERISTICS**

2-way valves, DN15-50

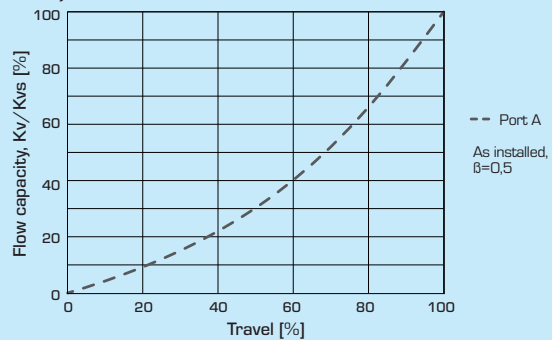

3-way valves, DN15-50

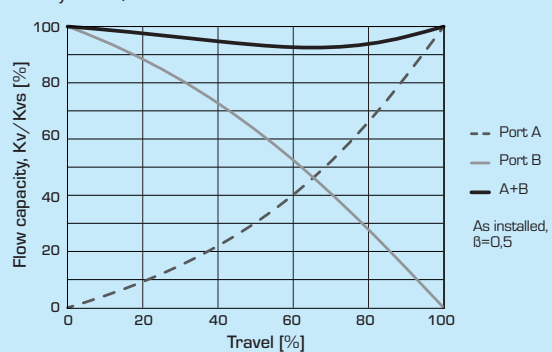

# CONTROL VALVE PN16 SERIES VLA121/VLA221 AND VLA131

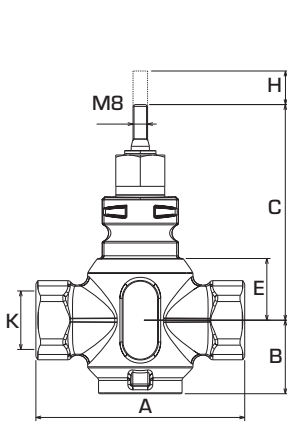

VLA121

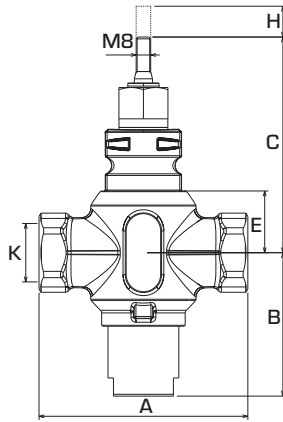

VLA221

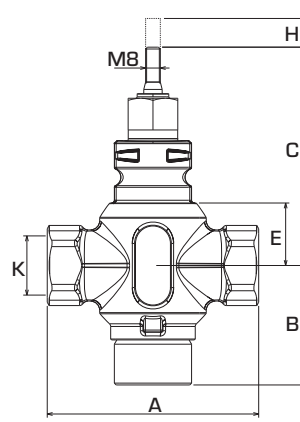

VLA131

## 2-WAY CONTROL VALVE SERIES VLA121

Art. No.	Reference	DN	Kvs *	A	B	C	E	H	K	Rangeability Kv/Kv <sup>min</sup>	Weight [kg]
2115 01 00	VLA121	15	1.6	85	38	108	24	20	Rp 1/2"	>50	1.0
2115 02 00			2.5								
2115 03 00			4								
2115 04 00	VLA121	20	6.3	100	40	115	30	20	Rp 3/4"	>50	1.2
2115 05 00	VLA121	25	10	115	40	119	34	20	Rp 1"	>50	1.3
2115 06 00	VLA121	32	16	130	41	120	35	20	Rp 1 1/4"	>50	1.8
2115 07 00	VLA121	40	25	150	50	128	42	20	Rp 1 1/2"	>50	2.7
2115 08 00	VLA121	50	38	180	59	138	53	20	Rp 2"	>50	4.2

## 2-WAY CONTROL VALVE SERIES VLA221 WITH PRESSURE BALANCED PLUG

Art. No.	Reference	DN	Kvs *	A	B	C	E	H	K	Rangeability Kv/Kv <sup>min</sup>	Weight [kg]
2115 17 00	VLA221	25	10	115	79	119	34	20	Rp 1"	>50	1.7
2115 18 00	VLA221	32	16	130	70	120	35	20	Rp 1 1/4"	>50	2.2
2115 19 00	VLA221	40	25	150	74	128	42	20	Rp 1 1/2"	>50	3.1
2115 20 00	VLA221	50	38	180	84	138	53	20	Rp 2"	>50	4.5

## 3-WAY CONTROL VALVES SERIES VLA131

Art. No.	Reference	DN	Kvs *	A	B	C	E	H	K	Rangeability Kv/Kv <sup>min</sup>	Weight [kg]
2115 09 00	VLA131	15	1.6	85	58	108	24	20	Rp 1/2"	>50	1.1
2115 10 00			2.5								
2115 11 00			4								
2115 12 00	VLA131	20	6.3	100	61	115	30	20	Rp 3/4"	>50	1.3
2115 13 00	VLA131	25	10	115	65	119	34	20	Rp 1"	>50	1.5
2115 14 00	VLA131	32	16	130	70	120	35	20	Rp 1 1/4"	>50	2.1
2115 15 00	VLA131	40	25	150	74	128	42	20	Rp 1 1/2"	>50	3.0
2115 16 00	VLA131	50	38	180	90	138	53	20	Rp 2"	>50	4.7

\* Kvs-value in m<sup>3</sup>/h at a pressure drop of 1 bar.