

Braukmann

F74CS-LF/FN74CS-LF

Lead-free reverse rinsing fine filter

Application

The reverse rinsing filters ensure a continuous supply of filtered water. The fine filter prevents the ingress of foreign bodies, for example rust particles, strands of hemp and grains of sand and thus reduces the probability of corrosion.

The fine filters are used in systems where an existing pressure reducing valve is fitted or where one is not required. Both horizontal and vertical installation is possible.

Approvals

- DVGW

approval for all filters with 100 µm mesh sizes and with rotatable connection piece

Special Features

- LEAD-FREE: Pb content of all materials less than 0.1 %
- Filtered water supplied even during reverse rinsing
- Patented reverse rinsing system - fast and thorough cleaning of the filter with small amount of water
- Memory ring indicates when next manual reverse rinsing is due
- Automatic reverse rinsing actuator with ISO flange connector can be retrofitted
- Large filter surface
- Shock resistant clear synthetic material filter bowl enables easy checking of filter contamination
- Filter insert fully replaceable
- ACS certified
- All materials are KTW approved
- Approved by TÜV LGA for low noise, Group 1 without limitations



Technical Data

Media	
Medium:	Drinking water
Connections/Sizes	
Connection sizes:	1/2" - 2" (with rotatable connector piece)
Pressure values	
Operating pressure range:	1.5 - 16 bar
Max. inlet pressure:	16 bar (up to 12 bar long-term*)
Operating temperatures	
Operating temperature range medium accord. to EN 1567:	5 - 30 °C
Specifications	
Installation position:	Horizontal or vertical, with filter bowl downwards

* For maintaining the measuring accuracy of the manometer, a continuous maximum pressure load of 12 bar is permitted.

Construction

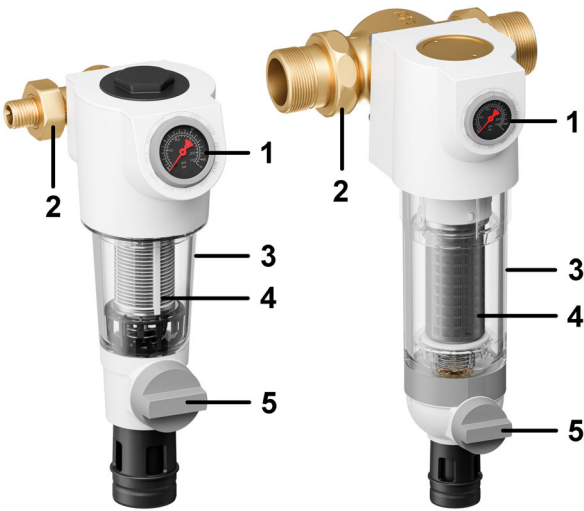
Overview		Components	Materials
	1	Housing with pressure gauge	F74CS-LF 1½" - 1¼": High-quality synthetic material F74CS-LF 1½" - 2": Lead-free brass
	2	Rotatable connector piece, flange sealings, connecting nuts and fittings (F74CS only)	F74CS-LF 1½" - 2": Lead-free brass
	3	Clear filter bowl	Shock-resistant, clear transparent synthetic material
	4	Fine filter	Stainless steel
	5	Reverse rinsing handle	Synthetic material filter mesh carrier, reverse rinsing handle and covers
	Not depicted components:		
		Memory ring	Plastic
		Allen key	Stainless steel
		Wrench for filter bowl and spring bonnet	Plastic
		Ball valve with drain connection	Lead-free brass (Ball Valve body), Stainless steel (ball), Plastic-durethan (drain adapter)
		Diaphragm	EPDM
		Sealing washers	EPDM

Method of Operation

The filter insert comprises an upper part and a lower combination section. When in the „filtering“ position, the small upper filter is closed so that the water can only pass through the main filter from outside to inside. When the ball valve is opened for reverse rinsing, the filter is pushed downwards until the water supply to the outer side of the main filter is stopped. Simultaneously, the water flow is opened to the upper part of the filter. The water needed for cleaning the filter passes through the upper sieve, the rotating impeller and the main filter from inside to outside. By this means, the filter is fully cleaned over its whole surface area at the full inlet pressure. The filter automatically switches over to the operating position when the ball valve is closed again.

Transportation and Storage

Keep parts in their original packaging and unpack them shortly before use.
The following parameters apply during transportation and storage:

Parameter	Value
Environment:	clean, dry and dust free
Min. ambient temperature:	5 °C
Max. ambient temperature:	55 °C
Min. ambient relative humidity:	25 % *
Max. ambient relative humidity:	85 % *

*non condensing

Installation Guidelines

Setup requirements

- The installation site has to be frost-proof and the protection of the device from chemicals, paints, detergents, solvents and their vapours and environmental influences must be guaranteed
- Install in horizontal or vertical pipework with filter bowl downwards
 - This position ensures optimum filter efficiency
- Install shut-off valves
- These filters are armatures which need to be maintained regularly
- Ensure good access (consider EN1717 requirements)
 - Pressure gauge can be read off easily
 - Degree of contamination can be easily seen with clear filter bowl
 - Simplifies maintenance and inspection
- It is recommended that a straight section of pipework at least five times the nominal valve size is provided after the filter (according to DIN EN 806-2)
- Fit immediately after water meter
- Related to the EN 806-2 it is recommended to install the filter immediately after the water meter
- In order to avoid flooding, it is recommended to arrange a permanent, professionally dimensioned wastewater connection

Installation Example

F74CS-LF 1½" - 1¼"

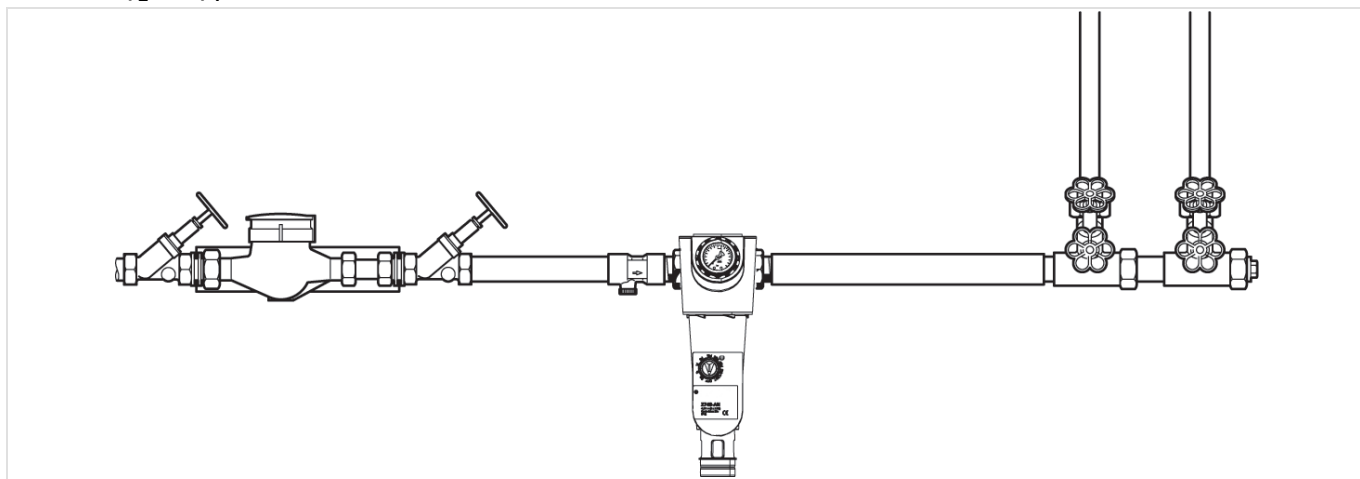

F74CS-LF 1½" - 2"

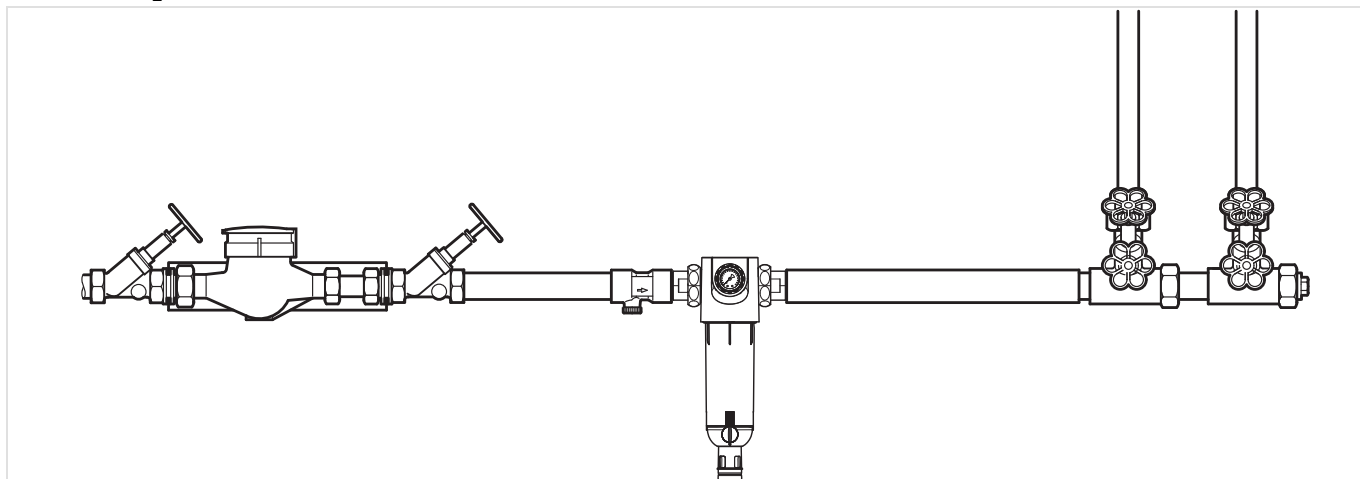

Technical Characteristics

kvs-Values

Connection size:	DN 15	DN 20	DN 25	DN 32	DN 40	DN 50
k _{VS} -value (m ³ /h):	5.3	7.9	9.0	10.0	16.0	20.0

Pressure drop characteristics

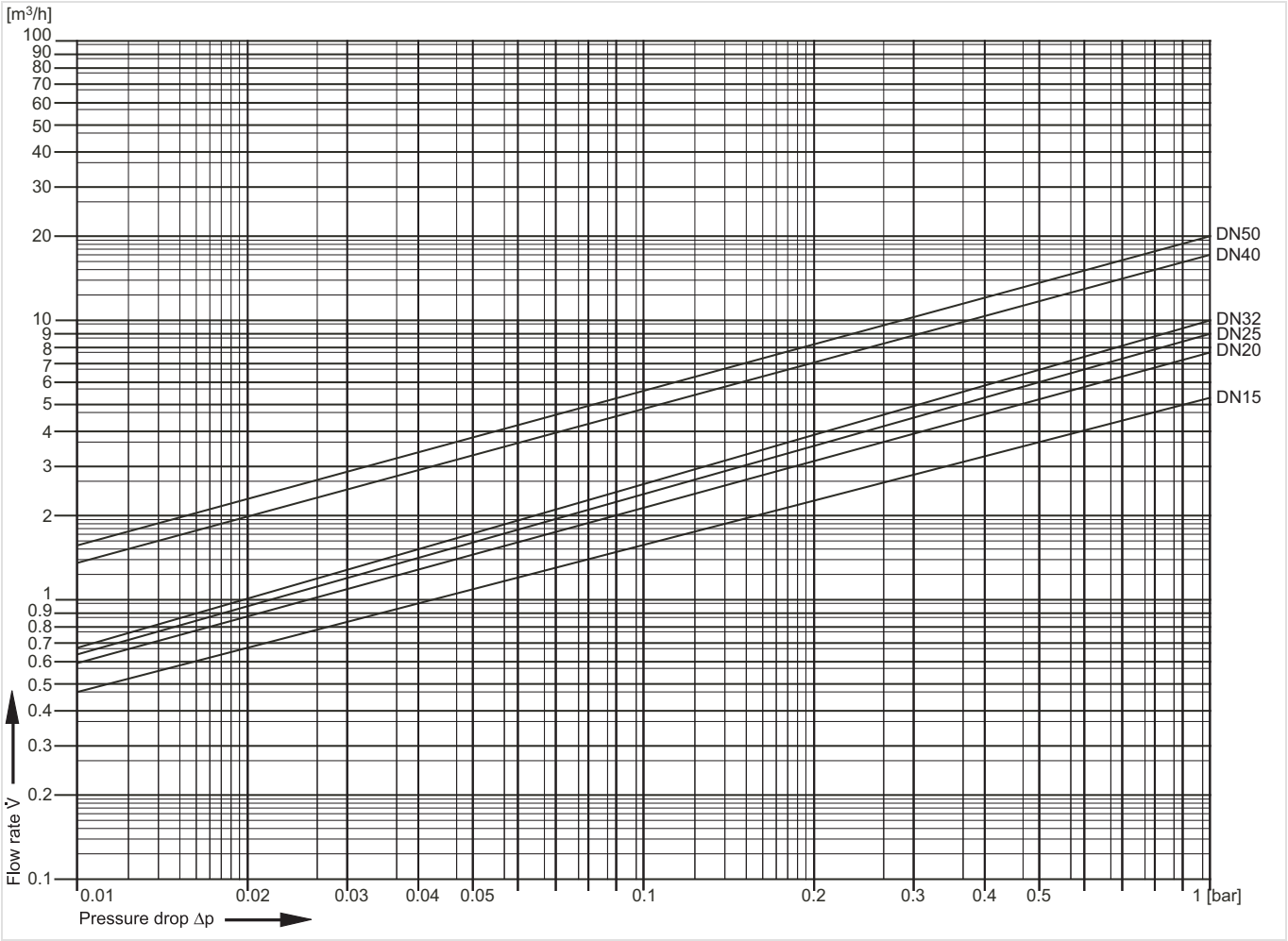

Dimensions

Overview

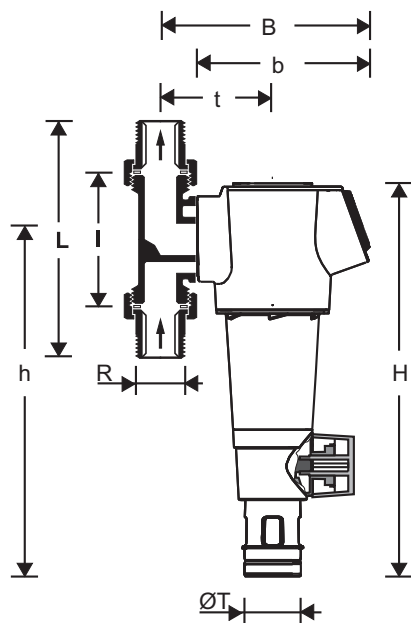

F74CS-LF 1/2" - 1 1/4"

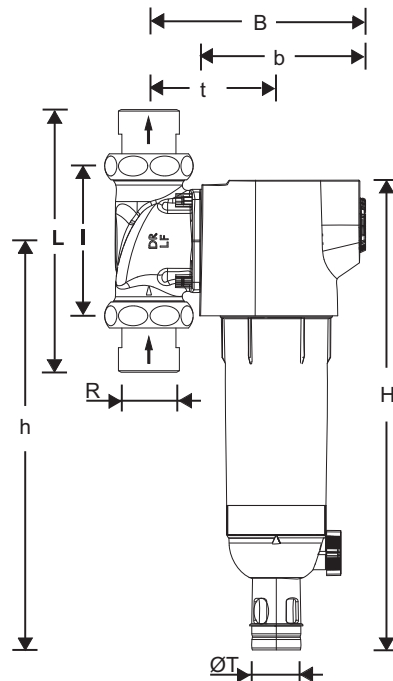

F74CS-LF 1 1/2" - 2"

Parameter		Values					
Nominal size diameter:	DN	DN15	DN20	DN25	DN32	DN40	DN50
Connection size:	R	1/2"	3/4"	1"	1 1/4"	1 1/2"	2"
Weight:	kg	2.1	2.1	2.3	2.6	9.273	10.121
Dimensions:	H	353	353	353	353	478	478
	h	298	298	298	298	416	416
	L	150	158	179	197	246	267
	I	90	90	100	105	150	150
	B	178	178	178	182	216	216
	b	150	150	150	150	187	187
	t	92	92	92	96	130	130
	ØT	50	50	50	50	50	50
Flow value at $\Delta p=0.2$ bar	m ³ /h	2.4	3.4	3.9	4.4	7.2	8.9
Flow value at $\Delta p=0.5$ bar:	m ³ /h	3.8	5.5	6.2	7.0	11.5	14.1

Note: All dimensions in mm unless stated otherwise.

Ordering Information

The following tables contain all the information you need to make an order of an item of your choice.

Options

Connection size:	Filter mesh size:	Rotable connector piece:	Item No.
1/2"	100 µm	Yes	F74CS-1/2LFAA
3/4"	100 µm	Yes	F74CS-3/4LFAA
1"	100 µm	Yes	F74CS-1LFAA
1 1/4"	100 µm	Yes	F74CS-1 1/4LFAA
1 1/2"	100 µm	Yes	F74CS-1 1/2LFAA
2"	100 µm	Yes	F74CS-2LFAA
1/2" - 1 1/4"	100 µm	No	FN74CS-1LFA
1 1/2" - 2"	100 µm	No	FN74CS-2LFA

Accessories

	Description	Dimension	Item No.
	DA74	Rotatable connector piece	
		For connection of retrofit filters and filter combinations	
	DZR brass	1/2"	DA74CS-1/2A
	DZR brass	3/4"	DA74C-3/4A
	DZR brass	1"	DA74C-1A
	DZR brass	1 1/4"	DA74C-11/4A
	lead-free	1/2"	DA74CS-1/2LFA
	lead-free	3/4"	DA74CS-3/4LFA
	lead-free	1"	DA74CS-1LFA
	lead-free	1 1/4"	DA74CS-11/4LFA
	lead-free	1 1/2"	DA74CS-11/2LFA
	lead-free	2"	DA74CS-2LFA
	lead-free, no connection parts	1/2" - 3/4"	DA74CS-1/2LFE
	lead-free, no connection parts	1"	DA74CS-1LFE
	lead-free, no connection parts	1 1/4"	DA74CS-11/4LFE
lead-free, no connection parts	1 1/2" - 2"	DA74CS-2LFE	
	ZR74CS	Double ring wrench for removing the filter bowl	
		1/2" + 1 1/4"	ZR74CS
	ZR10K	Double ring wrench for removing the filter bowl	
		1 1/2" + 2"	ZR10K-11/2
	RR74S	Automatic reverse rinsing actuator	
	For automatic filter cleaning at presettable intervals		
	with ISO-flange F03, 3 Nm, 230 V, 50 Hz, 5 W	1/2" - 1 1/4"	RR74S-A
	RR11S	Automatic reverse rinsing actuator	
	For automatic filter cleaning at presettable intervals		
	with ISO-flange F03, 5 Nm, 230 V, 50 Hz, 5 W, B MS		RR11S-A RR11S-AGB (UK-version)
	D06FR	Retrofit pressure reducing valve insert set	
	For retrofitting to upgrade to a filter combination		
		1/2" - 1 1/4"	D06FR-1LFA
		1 1/2" + 2"	D06FR-2LFA

	URS/URSP	Retrofit kit F*74CS		
		for filter bowl up to May 2025 with back wash actuator RR11S	1/2" - 1 1/4"	URSP-1AR
			1 1/2" + 2"	URS-11/2AR
		for filter bowl from June 2025 on with back wash actuator Z11S	1/2" - 1 1/4"	URSP-1NZ
			1 1/2" + 2"	URS-11/2NZ
				

Spare Parts

F74CS/FN74CS Fine filters from 2025 (lead-free) onwards

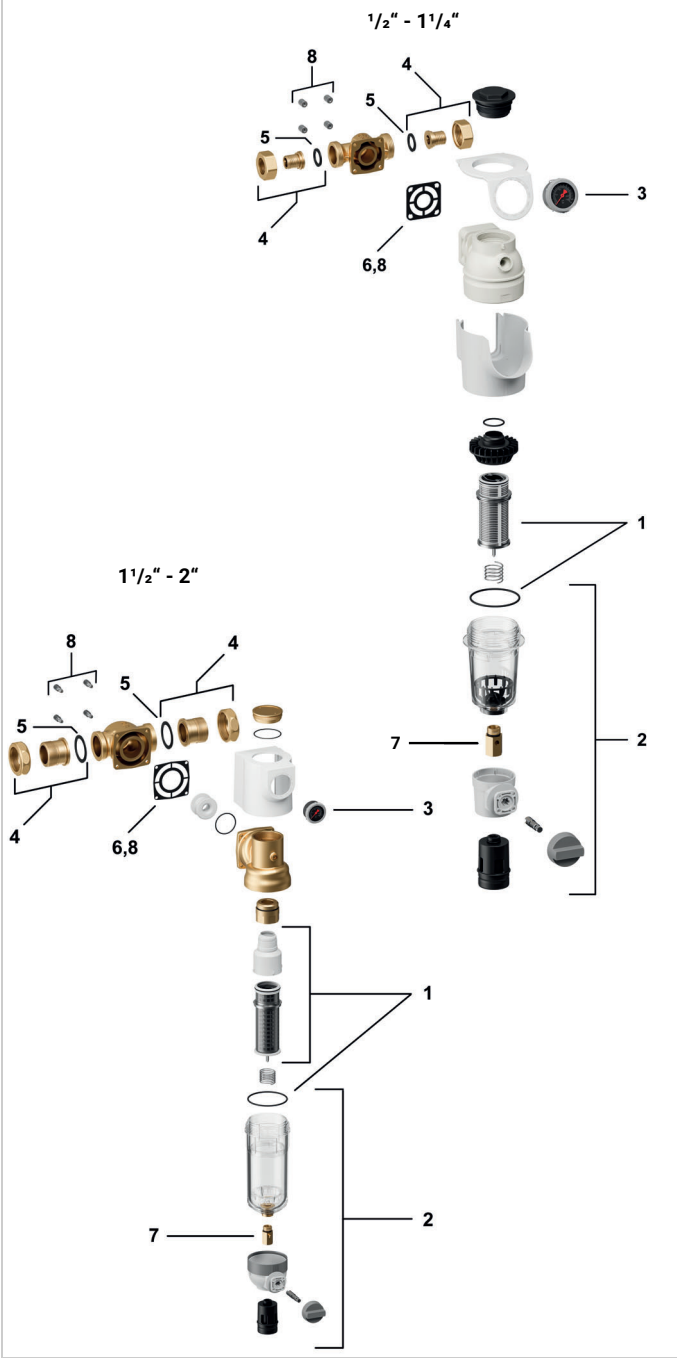
Overview	Description	Dimension	Item No.
	1 Filter insert complete		
	50 µm	1/2" - 1 1/4"	AF74-1C
	100 µm	1/2" - 1 1/4"	AF74-1A
	200 µm	1/2" - 1 1/4"	AF74-1D
	20 µm	1 1/2" - 2"	AF11S-11/2B
	50 µm	1 1/2" - 2"	AF11S-11/2C
	100µm	1 1/2" - 2"	AF11S-11/2A
	200 µm	1 1/2" - 2"	AF11S-11/2D
	2 Clear filter bowl		
	lead-free	1/2" - 1 1/4"	KF74CS-1LFA
	lead-free	1 1/2" - 2"	KF11S-11/2LFA
	3 Pressure gauge rear connection thread G1/4"		
		0 - 16 bar	M74CS-A16
	4 Connection set threaded connection		
	DZR brass	1/2"	VST06-1/2AR
	DZR brass	3/4"	VST06-3/4A
	DZR brass	1"	VST06-1A
	DZR brass	1 1/4"	VST06-11/4A
	lead-free	1/2"	VST74CS-1/2LFA
	lead-free	3/4"	VST06-3/4LFA
	lead-free	1"	VST06-1LFA
	lead-free	1 1/4"	VST06-11/4LFA
	lead-free	1 1/2"	VST74CS-11/2LFA
	lead-free	2"	VST06-2LFA
	5 Union seal washer (10 pcs.)		
		3/4"	0901444
		1"	0901445
		1 1/4"	0901446
		1 1/2"	0901447
		2"	0901448
	6 Flange seal		
		1/2" - 1 1/4"	5975900
		1 1/2" - 2"	5975901
	7 Ball valve complete		
	lead-free		KH11S-1LFA
	8 Flange seal incl. screws		
		1/2" - 1 1/4"	DS-FX74CS
		1 1/2" - 2"	DS-FX74CS-11/2